

APPROVED BY:
 NEW YORK STATE BOARD OF
 EQUALIZATION AND ASSESSMENT
 AUTHORIZED SIGNATURE: _____ S/ JOSEPH TAGGERT
 CASE NUMBER: 1638 DATE: FEBRUARY 4, 1990

THIS MAP PREPARED FOR ASSESSMENT PURPOSES ONLY
 AND NOT TO BE USED FOR THE CONVEYANCE OF PROPERTY

AUTHORIZED BY:
 ORDINANCE OF THE COMMON COUNCIL
 PASSED MAY 20, 1974
 PREPARED BY:
 SMITH & MAHONEY, CONSULTING ENGINEERS
 ALBANY, NEW YORK

MODULAR MAP BREAKDOWN	
01	02
03	04

REVISION TABLE		
DATE	BY	CHANGES OR ADDITIONS
10-20-11	JMO	NOTED: FROM 11-10 TO 76.06 AND RENUMBERED AS 76.05-THE RETIRED MAP 75.00
2-12-12	JMO	REMOVED MAPS 76.01, 76.04, 76.12, 76.16, 76.18, 76.19 AND MOVED ALL PARCELS TO NEW MAP 75.00

LEGEND	
RAIL ROAD	STREET OR ROAD
STREAM OR DITCH	INTERSTATE HIGHWAY Rte. No. (20)
ROAD OR RAILROAD BNDY.	U.S. HIGHWAY Rte. No. (20)
MAP LIMIT LINE	N.Y.S. HIGHWAY Rte. No. (88)
COUNTY LINE	COUNTY ROAD NO. (194)
CITY LINE	TAX MAP SECTION No. 74.00
TOWN LINE	

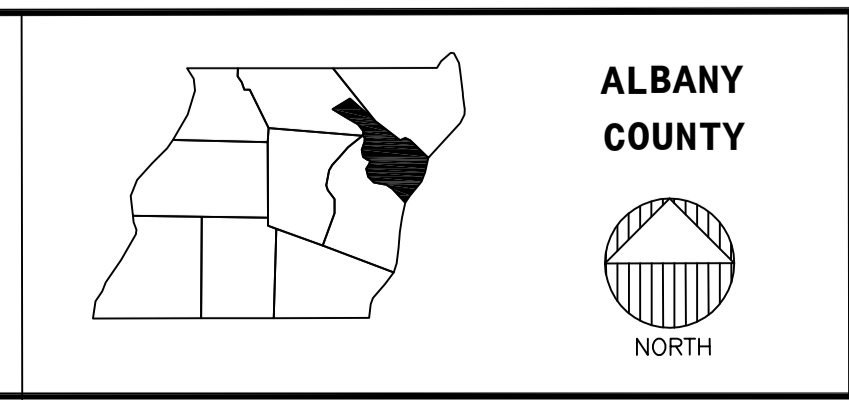
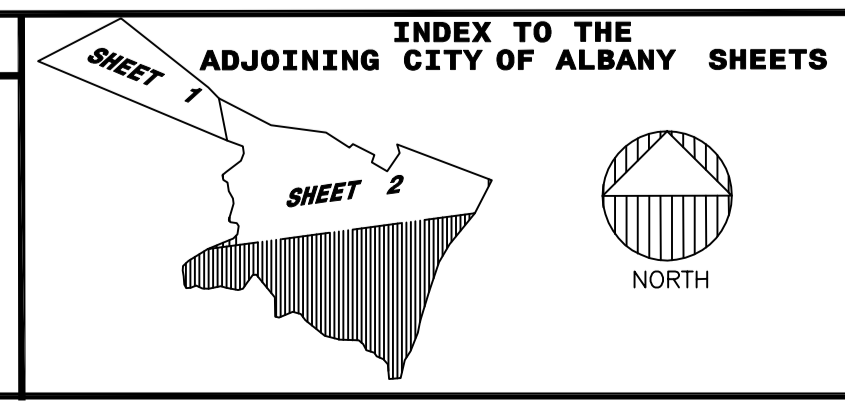

TAX MAP
CITY OF ALBANY
 ALBANY COUNTY, NEW YORK
 GRAPHIC SCALE: 1" = 800'
 TAXABLE STATUS DATE: 3/1/12
SHEET 3
 INDEX MAP

© Copyright 2012
 County of Albany, NY, USA